

PVC-U True union ball check valves CB

PVC-U Valvole di ritegno bighiera a sfera CB

Rev. Feb 2021

CB valve is a PVC-u ball check valve ideal for use in applications that require precise closure and for conveying dirty fluids, even with suspended solids and filaments. CB check valve is suitable for use in water treatment, SPAs and pools.

Le valvole CB sono valvole di ritegno a sfera in PVC-u, ideali per applicazioni che richiedono una chiusura precisa e convogliamento di fluidi sporchi anche con solidi o filamenti in sospensione. Le valvole di non ritorno CB sono adatte per utilizzo nei settori del trattamento acque, delle SPA e delle piscine.

- Suitable for vertical installation.
Adatta per installazione verticale.
- High-surface finish machined ball.
Sfera in PVC lavorata ad alta finitura superficiale.
- EPDM or FKM seals available.
Disponibile con guarnizioni in EPDM o FKM.
- Marine Application Certificate.
Certificata per applicazioni navali.

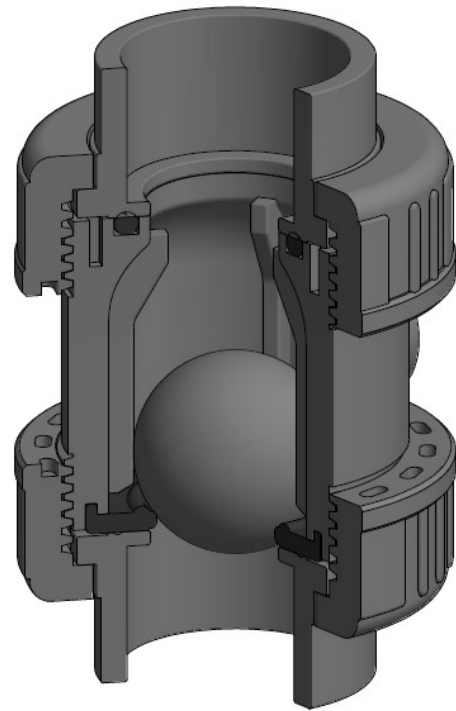

TECHNICAL FEATURES / CARATTERISTICHE TECNICHE

NOMINAL PRESSURE / PRESSIONE NOMINALE	PN 16 (20°C)
DIMENSIONS / DIMENSIONI	DN 15 ÷ DN 50 (d.16 ÷ 63 mm – 1/2" ÷ 2")
VALVE MATERIAL / MATERIALE VALVOLA	PVC-U
SEALS MATERIAL / MATERIALE GUARNIZIONI	O-rings: EPDM or FKM / O-ring: EPDM o FKM
TEMPERATURE RANGE / TEMPERATURA	0°C ÷ 60°C
COUPLING STANDARDS / GIUNZIONI	Solvent welded sockets: metric, BS / Manicotti incollaggio: metrici, BS Threaded sockets: BSPP / Manicotti filettati BSPP On request: JIS or ASTM solvent welded sockets, NPT threaded sockets / A richiesta: manicotti per incollaggio JIS e ASTM, manicotti filettati NPT



Certifications and approvals: only for items declared on Official Listing or certificates. / Certificazioni: solo per gli articoli dichiarati nelle Official Listing o nei certificati stessi.

PVC-U True union ball check valves CB

PVC-U Valvole di ritegno bighiera a sfera CB

Operating pressure / Pressione di esercizio

Maximum operating pressure for PVC-U: according to temperature as shown in graph.

Massima pressione di esercizio per il PVC-U: secondo quanto indicato nel grafico in figura.

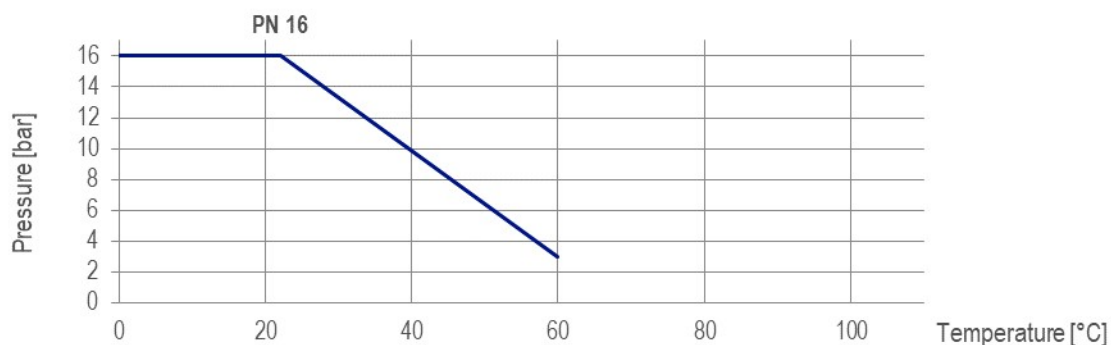

Pressure loss / Perdite di carico

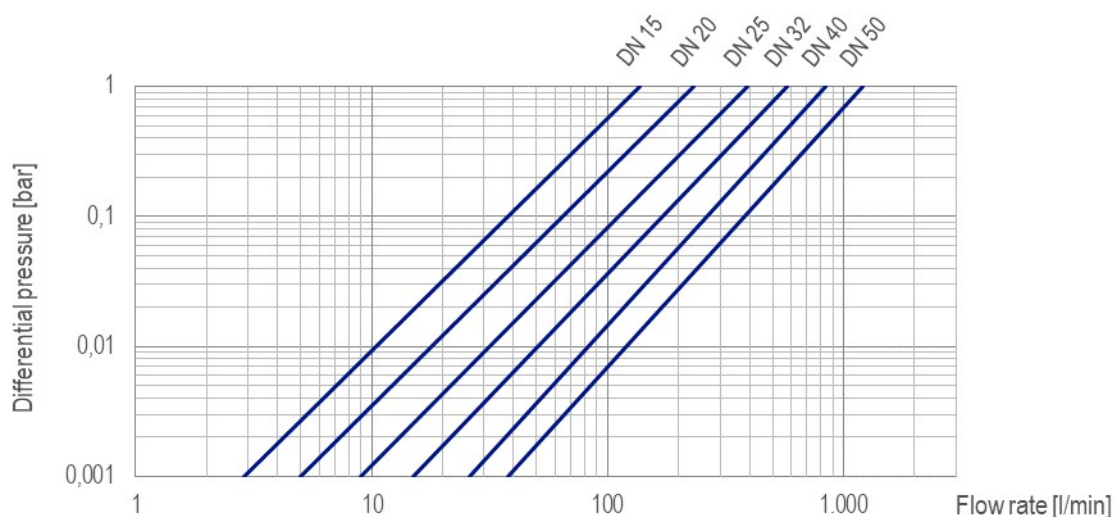

Flow rate coefficient Kv100 / Coefficiente di flusso Kv100

At $\Delta p = 1$ bar. Kv100 flow coefficient is the flow rate of water at 20°C that will generate 1 bar pressure drop. The Kv100 values in the table are calculated for the valve completely open.

Per $\Delta p = 1$ bar. Il coefficiente di flusso Kv 100 è la portata dell'acqua a 20° che genera una caduta di pressione di 1 bar. I valori di Kv100 riportati in tabella sono calcolati per la valvola completamente aperta.

DN	DN 15	DN 20	DN 25	DN 32	DN 40	DN 50
l/min	137	232	390	579	835	1209

Minimum valve sealing pressure / Pressione minima di tenuta della valvola

DN	DN 15	DN 20	DN 25	DN 32	DN 40	DN 50
bar	0.2	0.2	0.2	0.2	0.2	0.2

PVC-U True union ball check valves CB
PVC-U Valvole di ritegno bighiera a sfera CB

Components / Componenti

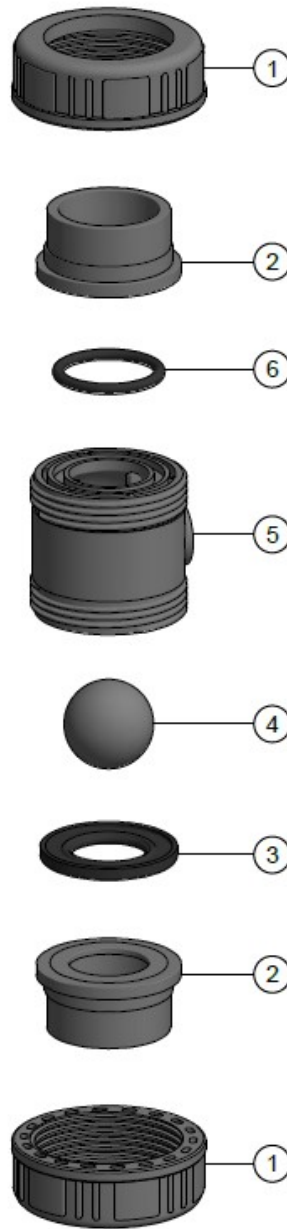

n.	COMPONENT	MATERIAL	Qty	n.	COMPONENT	MATERIAL	Qty
1	Nut / Ghiera	PVC-U	2	4	Ball / Sfera	PVC-U	1
2	Socket / Manicotto	PVC-U	2	5	Body / Corpo	PVC-U	1
3	Gasket / Guarnizione	EPDM/FKM	1	6	Socket O-ring / O-ring manicotto	EPDM/FKM	1

All descriptions and illustrations in this publication are intended for guidance only and shall not constitute a 'sale by description'. All dimensions given are nominal, while changes can be done on the information, products and specifications from time to time for a variety of reasons, without prior notice. The information in this publication is provided 'as is' on the revision date stated on the sheet. Updates will not be issued automatically. This information is not intended to have any legal effect, whether by way of advice, representation or warranty (express or implied). We accept no liability whatsoever (to the extent permitted by law) if you place any reliance on this publication you must do so at your own risk. All rights reserved. Copyright in this publication belongs to Polypipe Italia and all such copyright may not be used, sold, copied or reproduced in whole or part in any manner in any media to any person without prior consent. **EFFAST** is a registered trademark.